



jordanfishwick

12 DRAYFORD CLOSE MANCHESTER M23 0GF
PCM £850 PCM

12 DRAYFORD CLOSE MANCHESTER M23 0GF

*** AVAILABLE MARCH *** Modern studio flat with Private Entrance. Situated within a popular residential area, close to Sale Moor village and only a stones throw away from the new Metro Link Station. This property comprises private entrance, modern bathroom with shower over bath, stairs leading to first floor, good size lounge and bedroom and fully fitted kitchen with appliances. Ample parking available. Offered on a Furnished basis. Call now to view.

GROUND FLOOR

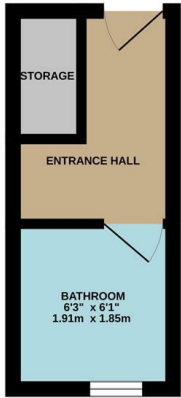

1ST FLOOR

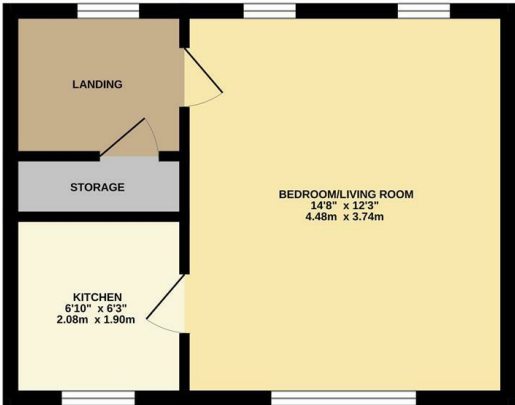

Measurements are approximate. Not to scale. Illustrative purposes only. Made with Metropix ©2025

- ONE BEDROOM FLAT
- PRIVATE ENTRANCE
- FURNISHED
- CLOSE TO METROLINK
- CLOSE TO LOCAL SHOPS
- EPC RATING - C
- COUNCIL TAX BAND A
- PARKING

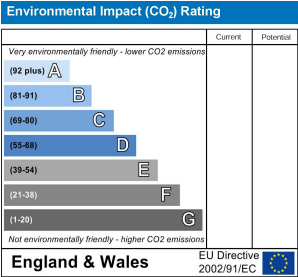
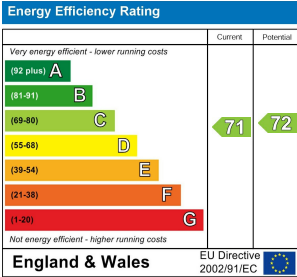

These particulars are believed to be accurate but they are not guaranteed and do not form a contract. Neither Jordan Fishwick nor the vendor or lessor accept any responsibility in respect of these particulars, which are not intended to be statements or representations of fact and any intending purchaser or lessee must satisfy himself by inspection or otherwise as to the correctness of each of the statements contained in these particulars. Any floorplans on this brochure are for illustrative purposes only and are not necessarily to scale.

Offices at: Chorlton, Didsbury, Disley, Hale, Glossop, Macclesfield, Manchester Deansgate, Manchester Whitworth Street, New Mills, Sale, Wilmslow and Withington

36-38 Alderley road, Wilmslow SK9 1JX

01625 532000

wilmslow@jordanfishwick.co.uk
www.jordanfishwick.co.uk